



The Arboretum

State Botanical Garden of Kentucky

University of Kentucky and Lexington Fayette Urban County Government

Your very own

MAP

to Garden Treasures...

The Arboretum is a living museum of plants.

Some plants you will see are trees and shrubs that have stems and branches made of wood. There are other plants that don't have any woody parts at all, like flowers, vegetables, and grasses. You will also see wild animals, birds, rocks, stones, water, and fish.

Have fun playing the Arboretum garden game!

- 1. Name the tallest tree in the Arboretum garden.
2. In the herb garden, find an herb named after a woman. What is it called?
3. Find the butterfly bush in the butterfly garden. What is its scientific name?
4. Near the potting shed, look at the compost pile and guess what is in it.
5. Look in the fishpond. Name a moving creature and a plant you see living there.
6. Name a tree with needles for leaves and cones for seeds.
7. Look for an old-fashioned stone fence. What kind of stone is in the fence?
8. Name a plant growing as a vine.
9. Find an oak tree with leaves whose edges look like a saw. What is its name?

- 10. Make up a name for your favorite water fountain sculpture.
11. Which plant in the Arboretum has the largest leaf?
12. Bunnies, chipmunks, and birds all live in the Arboretum. Name the wild animals you saw today.
13. In the rose garden, find a rose named after a President. What is it called?
14. In the rose garden, can you find a bed of miniature roses? Write down some of their colors.
15. In the rose garden, can you find climbing roses? Can you name one of them?
16. Can you find a hedge in the garden? Do the branches have thorns?
17. Find the garden trellis. Are there plants growing on the trellis?
18. Find the fragrance garden. Which plant has the best smell?
19. Find the vegetable garden. Which vegetable in the garden is your favorite?
20. Find a plot in the garden that is adopted. Do you know anyone who has adopted a garden plot at the Arboretum?

Admission is free

Thanks for coming to the Arboretum!

The Dorothea Smith Oatts Visitor Center is open M-F 8:30 a.m.-4:00 p.m. www.uky.edu/Arboretum

The Arboretum is open 365 days a year from dawn to dusk. (859) 257-6955

MAP

- A. Entrance
- B. Gazebo
- C. Rose garden
- D. Stone fences
- E. Perennial garden
- F. Fish pond
- G. Fountains with sculptures
- H. Butterfly garden
- I. Trellis
- J. Herb garden
- K. Potting & tool sheds
- L. Vegetable plots
- M. Annual flowers
- N. Home fruit plantings
- O. Children's garden
- P. Fragrance garden

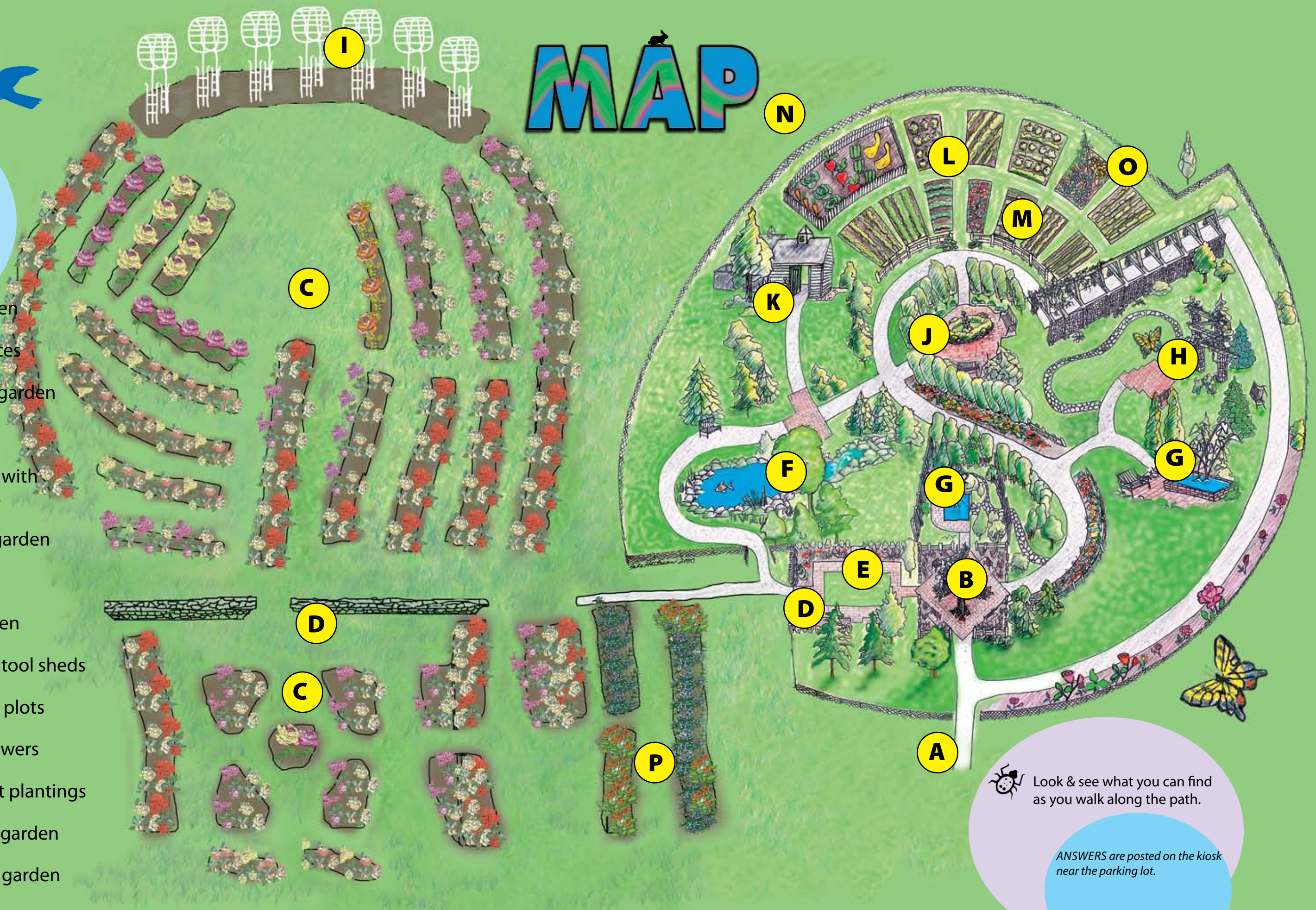

 Look & see what you can find as you walk along the path.

ANSWERS are posted on the kiosk near the parking lot.